

MAIN FLOOR | 642 sq. ft.

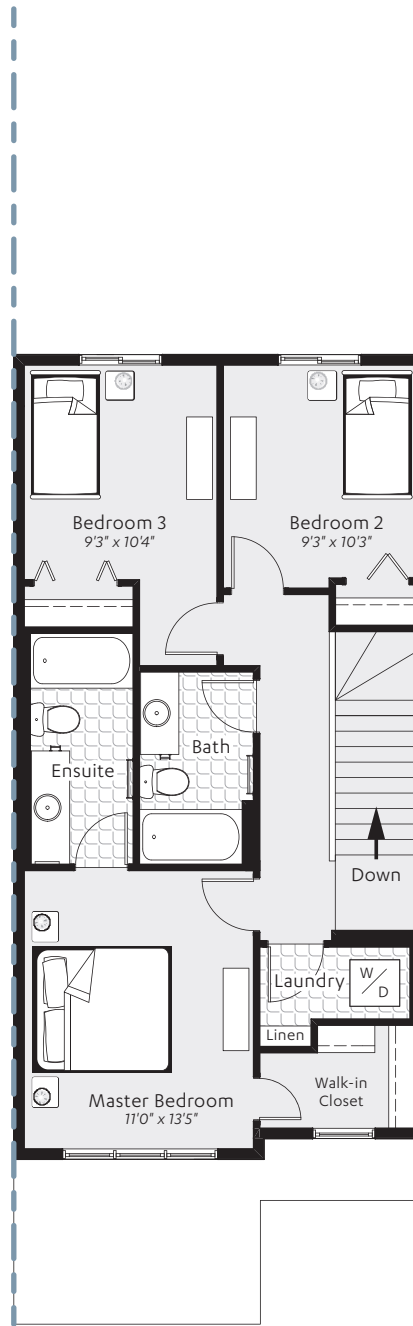

SECOND FLOOR | 772 sq. ft.



**EXCEL HOMES
SHOW HOME**

HARRISON

in Carrington

FRONT GARAGE DUPLEX
TWO STOREY

BATHROOMS

2.5

BEDROOMS

3

FINISHED SQ. FT.

1414

**EXCEL
HOMES**

excelhomes.ca

OVER 50 AWARDS FOR
DESIGN EXCELLENCE



This floorplan represents one version of this home and measurements are approximate. The square footage, measurements and layout may vary based on the elevation and/or lot. All elevations shown are artist's concept only and will vary by community. The builder reserves the right to make modifications or substitutions should they be necessary. All plans, options, dimensions, specifications, materials and drawings are subject to change without notice. Last updated October 27, 2016. E.&O.E.

THIS SHOW HOME FEATURES THE FOLLOWING OPTIONS AND UPGRADES

The following icons **A1** shown beside options and upgrades can be found in the standard brochure.

MAIN FLOOR:

- Laminate Flooring to Main Floor: Warm Grey

KITCHEN:

- Kitchen Upgrade Level 1 **A2**
- Pot Light Kitchen Layout **A3**
- Granite Countertop in Kitchen: Elegant White
- Backsplash: Feng Shui - Glossy White

GREAT ROOM:

- Great Room Fireplace Location – Detail #LT12 **B1**
- Fireplace Tile: Skybridge – Gray
- Pot Light Great Room Layout **B2**

SECOND FLOOR:

- Carpet: Fossil

ENSUITE:

- Lino Flooring: Graphite
- Backsplash: Skybridge – Gray

BATHS:

- Lino Flooring: Graphite
- Backsplash: Skybridge – Gray

LAUNDRY:

- Lino Flooring: Graphite

BASEMENT:

- Bath Rough-in to Basement **C1**

EXTERIOR:

- Rear Deck/Patio **C1**
- Gas Line for BBQ **C2**

OTHER:

- Vista Selections – Elevation C
- Knockdown Ceiling Texture
- Security Pre-wiring
- 3 Audio Zone Systems
- Show Home Landscaping

EXCEL HOMES
SHOW HOME

HARRISON
in Carrington

ADDRESS

465 CARRINGVUE
AVENUE NW

FOR MORE INFORMATION,
PLEASE CONTACT:

Katie Schock

AREA MANAGER
403-457-1782

EXCEL
HOMES

excelhomes.ca