



# Windsor

LANED HOME  
TWO STOREY

2.5 BATH | 3 BED | 1742 FINISHED SQ.FT.

642  
OPTIONAL  
BASEMENT  
DEVELOPMENT  
SQ.FT.

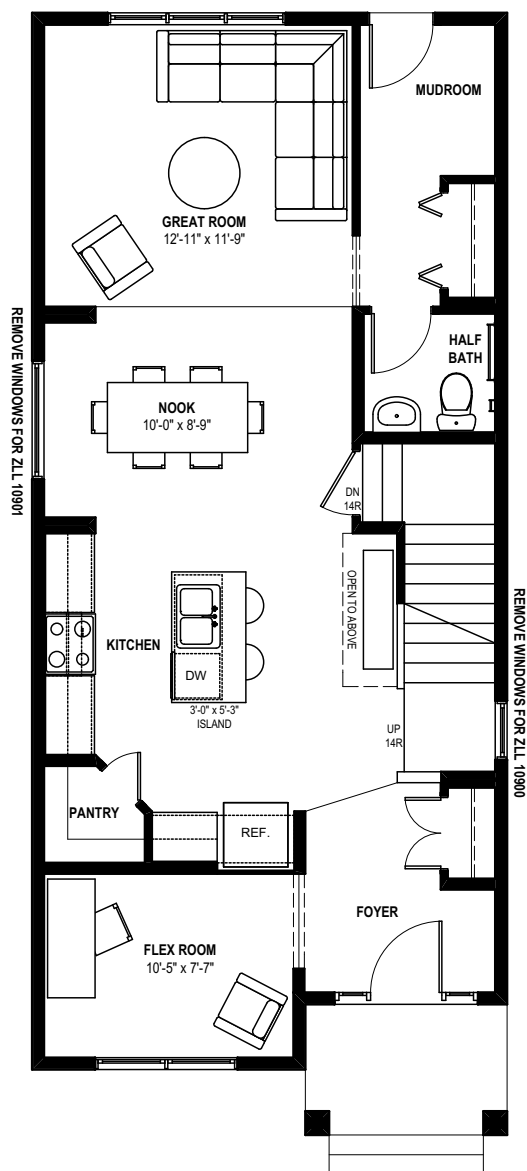

MAIN FLOOR | 867 sq. ft.

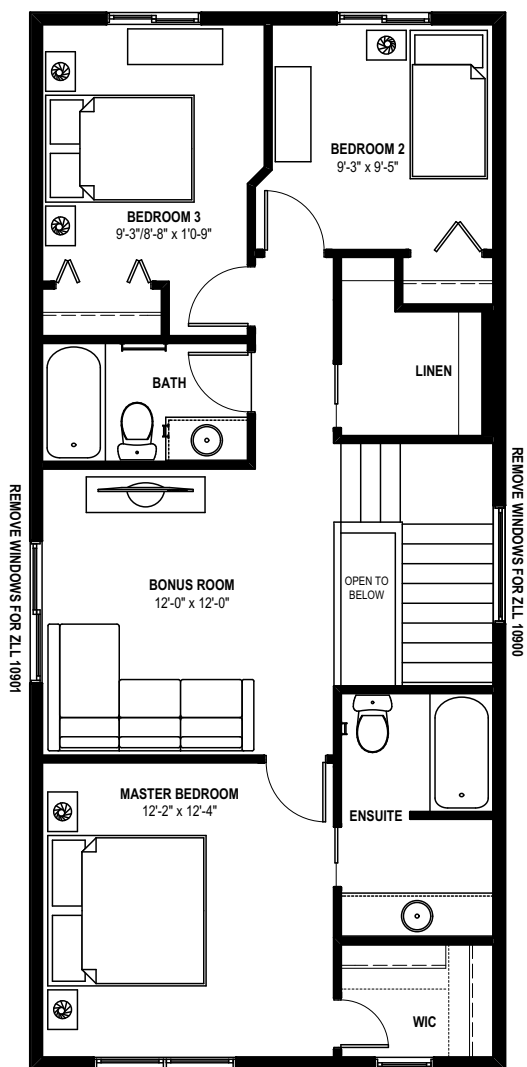

SECOND FLOOR | 875 sq. ft.



OVER 50  
AWARDS  
FOR DESIGN  
EXCELLENCE



This floorplan represents one version of this home and measurements are approximate. The square footage, measurements and layout may vary based on the elevation and/or lot. All elevations shown are artist's concept only and will vary by community. The builder reserves the right to make modifications or substitutions should they be necessary. All plans, options, dimensions, specifications, materials and drawings are subject to change without notice. Last updated March 8, 2019. E.&O.E.

# Windsor

## MAIN FLOOR OPTIONS

### A1 Kitchen Upgrade (for 8' or 9' Ceiling)

- Includes crown moulding
- Island revisions

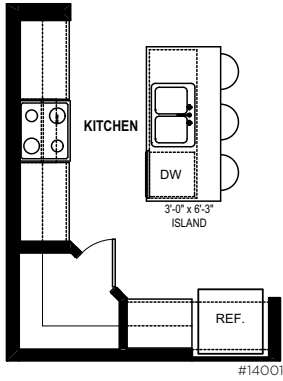

### A2 Kitchen Upgrade Level 1 (for 8' or 9' Ceiling)

- Includes crown moulding
- Island revisions
- Cabinet upgrade to max 42" upper cabinets with step up above hoodfan, microwave and fridge
- One set of pots and pans drawers

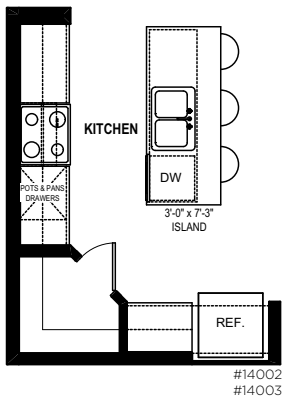

### A3 Kitchen Upgrade Level 2 (for 9' Ceiling)

- Includes crown moulding
- Island revisions
- Cabinet upgrade to max 42" upper cabinets with consistent finished height throughout
- Two sets of pots and pans drawers
- Chimney-style hoodfan included with full height tile behind
- Built-in microwave with trim kit (below counter)

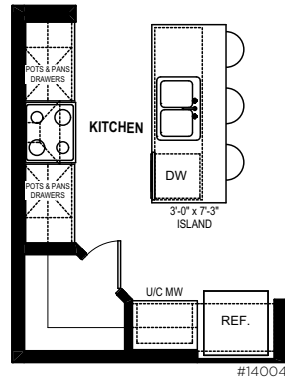

### A4 Kitchen Upgrade Level 3 (for 9' Ceiling)

- Includes crown moulding and, or riser tight to ceiling
- Island revisions
- Cabinet upgrade to max 42" upper cabinets with consistent finished height throughout
- Three sets of pots and pans drawers (one to each side of cooktop and one below cooktop)
- Chimney-style hoodfan included with full height tile behind
- Built-in microwave and wall oven with trim kit
- Electric cooktop included with lower base cabinet

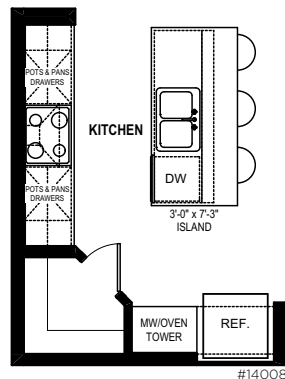

### A5 Kitchen Upgrade Level 4 (for 9' Ceiling)

- Includes crown moulding and, or riser tight to ceiling
- Island revisions
- Stacked upper cabinets (36" and 12" with glass inserts and lighting)
- Three sets of pots and pans drawers
- Chimney-style hoodfan included with full height tile behind
- Built-in microwave and wall oven with trim kit
- Tip-out sink tray
- Pull out garbage, recycle drawer over counter areas
- Undercabinet lighting over counter areas

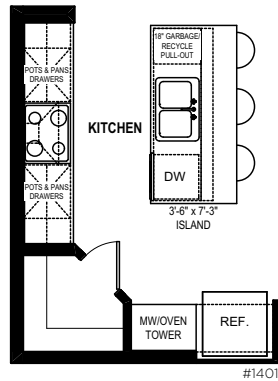

### A7 Add French Door to Flex Room

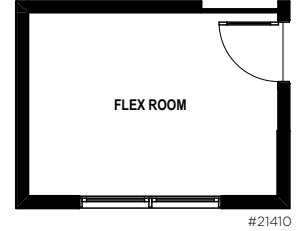

### A8 Add French Door to Pantry

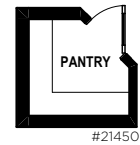

### A6 Add Pot Lights to Kitchen

- Includes 6" pot lights and dimmer switch

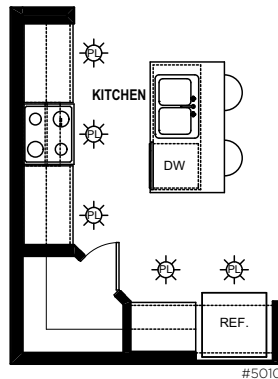

Note: Actual number and location of pot lights may vary based on site conditions.

# Windsor

## MAIN FLOOR OPTIONS

**B1** Add Bench to Mudroom

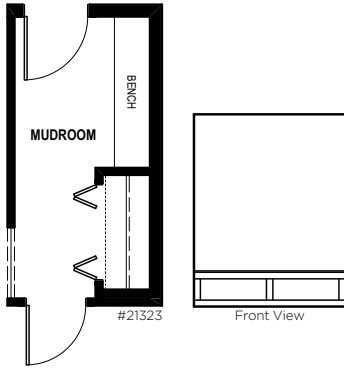

**C1** Add Electric Fireplace to Great Room

- Choice of fireplace finishing upgrade options also available.

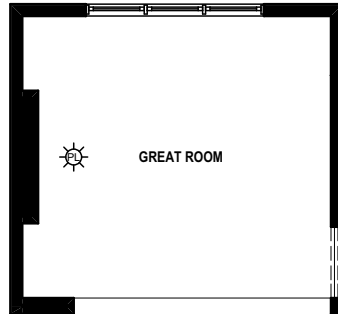

Note: Choice of fireplace finishing options available, see your sales representative for details.

**C4** Add Pot Lights to Great Room

- Includes 6" pot lights and dimmer switch

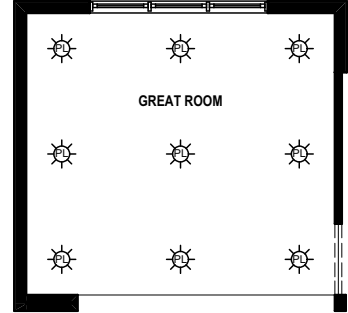

Note: Actual number and location of pot lights may vary based on site conditions. Light near location of fireplace is adjusted with purchase of a fireplace.

**B2** Add Lockers to Mudroom

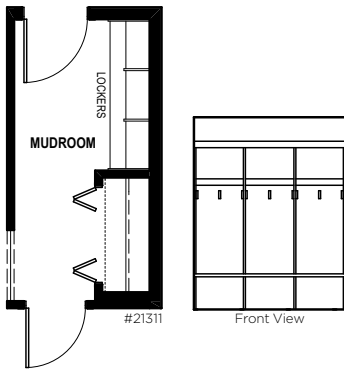

**C2** Add Gas Fireplace to Great Room

- Choice of fireplace finishing upgrade options also available.

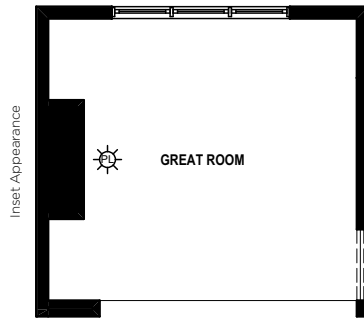

Note: Choice of fireplace finishing options available, see your sales representative for details, Required for zero lot line homes.

**D1** Rear Deck

- Deck materials as selected on Schedule B

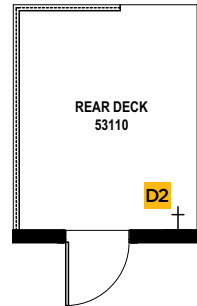

Note: Deck, Patio height and stairs from patio doors and to yard may vary based on site conditions. Location of Gas Line shown for reference.

**C3** Add Gas Fireplace to Great Room

- Choice of fireplace finishing upgrade options also available.

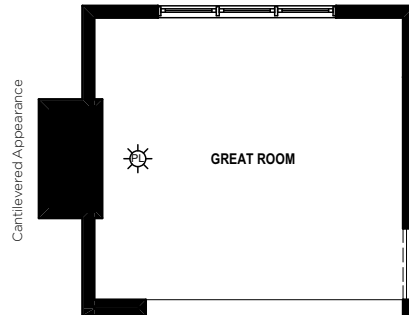

Note: Choice of fireplace finishing options available, see your sales representative for details.

**D2** Gas Line for BBQ

Note: See Rear Deck, Patio option for location of gas line. Purchase of Rear Deck, Patio option is not required, gas line can be sold separately.

**E1** 9' Ceiling to Main Floor

- Risers added to stairwell

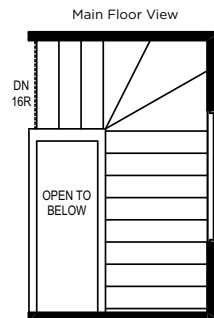

Note: This option is only available in an undeveloped basement.

# Windsor

## SECOND FLOOR OPTIONS

### F1 Add Pot Lights to **A** Bonus Room

- Includes 6" pot lights and dimmer switch

Check Option Below if on Schedule B:

- Ceiling Fan Rough-In Location **B** #974098206

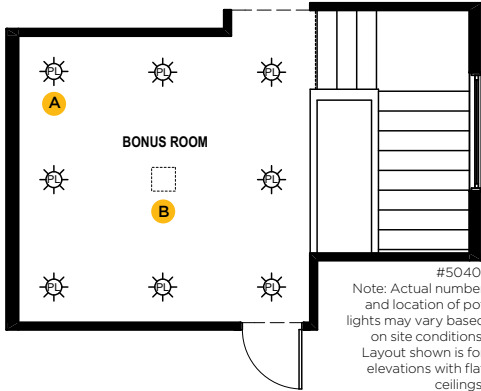

### F3 Add Vaulted Ceiling **A** to Bonus Room

Check Option Below if on Schedule B:

- Ceiling Fan Rough-In Location **B** #974098206
- Pot Lights **C** #50401

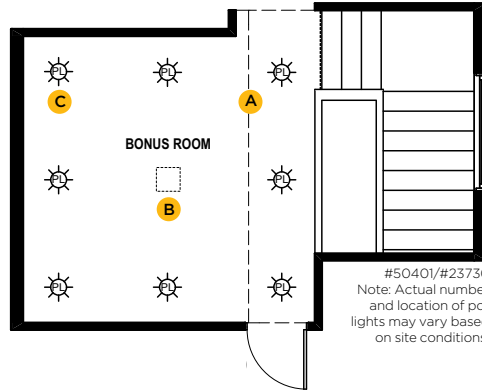

### F2 Add Vaulted Ceiling **A** to Bonus Room

Check Option Below if on Schedule B:

- Ceiling Fan Rough-In Location **B** #974098206
- Pot Lights **C** #50401

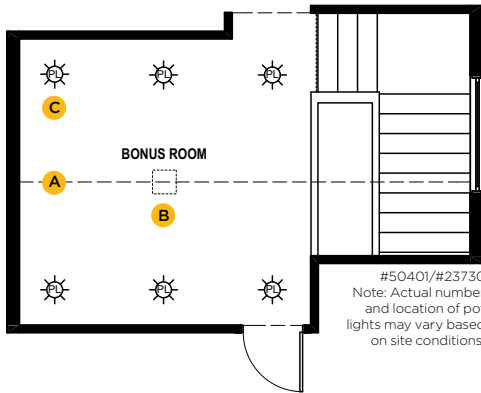

# Windsor

## SECOND FLOOR OPTIONS

- G1** **Ensuite Upgrade**
- Upgrade to soaker tub
  - Acrylic shower unit with tile surround and sliding shower door with chrome frame
  - Cabinet style medicine cabinet

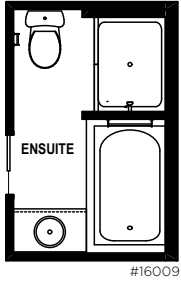

- G5** **Add Bank of Drawers and Dual Sinks to Ensuite**
- Second sink added to vanity
  - Bank of drawers added to vanity

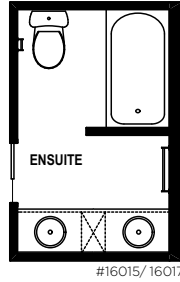

- I1** **Laundry Upgrade Level 1**
- Laminate countertop above washer and dryer with wire shelf above
  - 6" tile backsplash above countertop

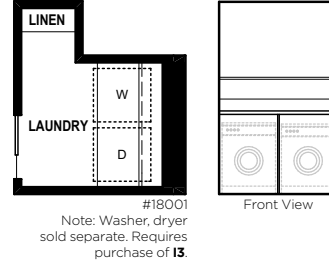

- G2** **Add Dual Sinks to Ensuite**
- Second sink added to vanity

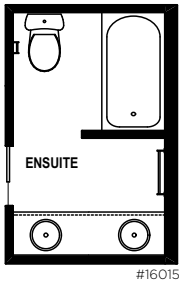

- G6** **Shower to Ensuite in Lieu of Tub**
- Tub shower changed to acrylic shower unit with tile surround and sliding glass door with chrome frame

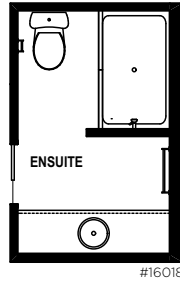

- I2** **Laundry Upgrade Level 2**
- Laminate countertop above washer and dryer with wire shelf above
  - 6" tile backsplash above countertop
  - Upper cabinets with wire shelf and hanging rod

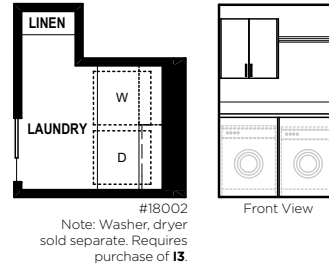

- G3** **Add Bank of Drawers to Ensuite**
- Bank of drawers added to vanity

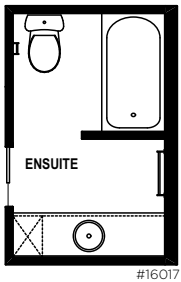

- H1** **Add Bank of Drawers to Main Bath**

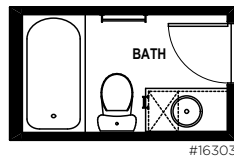

- I3** **Move Laundry Rough-in from Basement to Second Floor (side-by-side)**

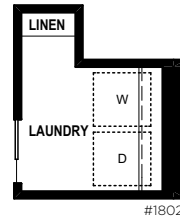

Note: Re-sizing of other rooms may be required to accommodate (as shown). This option is required in order to purchase Laundry Level 1, 2 or 3. Washer, dryer sold separate.

# Windsor

## RAILING OPTIONS

**J1** Railing Upgrade Level 1  
- Railing added on main floor leading up to landing

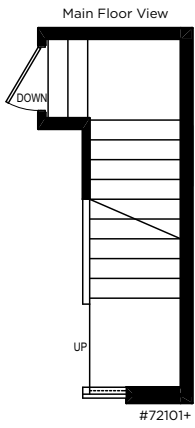

**J2** Railing Upgrade Level 2  
- Railing added on main floor leading up to second floor

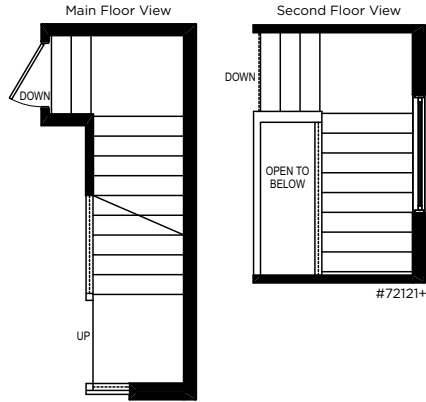

# Windsor

## BASEMENT OPTIONS

**K1** Basement Development Option 1 | 642 sq.ft.  
- Includes upgrade to 9' basement height

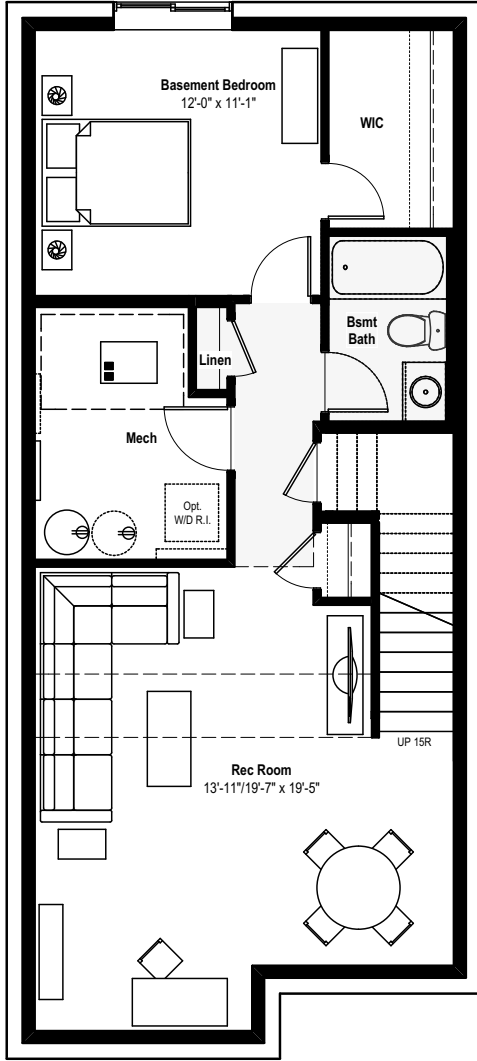

#26001  
Note: Door on main floor leading down to basement is removed. Requires the purchase of **K12** separately.

**K2** Add Pot Lights to Basement Development Option  
- Includes 6" pot lights and dimmer switch

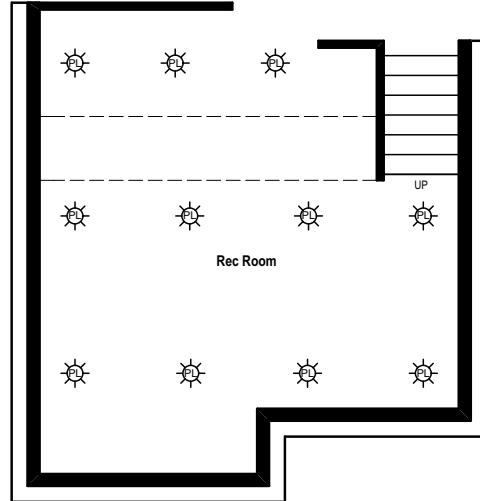

#50501  
Note: Actual number and location of pot lights may vary based on site conditions.

**K3** Wet Bar Upgrade Level 1  
- Laminate countertop with lower cabinets  
- Stainless steel undercounter fridge  
- 6" tile backsplash  
- Two 4" LED pot lights above

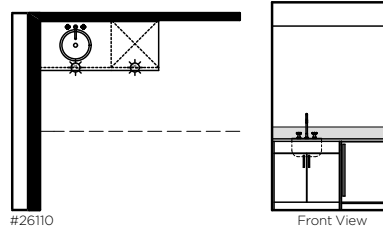

#26110  
Note: Location of pot lights may vary based on site conditions.

**K4** Wet Bar Upgrade Level 2  
- Laminate countertop with lower cabinets  
- Stainless steel full size fridge  
- Undercounter dishwasher  
- 6" tile backsplash  
- Linoleum flooring as shown

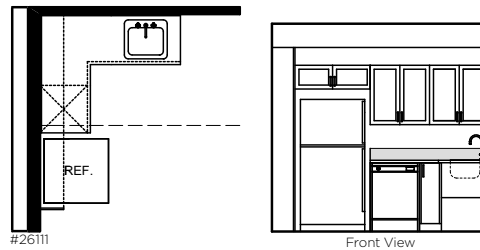

#26111  
Front View

This floorplan represents one version of this home and measurements are approximate. The square footage, measurements and layout may vary based on the elevation and/or lot. All elevations shown are artist's concept only and will vary by community. The builder reserves the right to make modifications or substitutions should they be necessary. All plans, options, dimensions, specifications, materials and drawings are subject to change without notice. Last updated March 8, 2019. E.&O.E.

# Windsor

## BASEMENT OPTIONS

**K5** Shower to Bath in Basement Development Option  
- Tub upgraded to acrylic shower

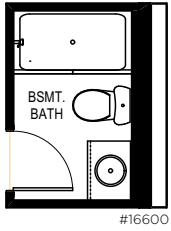

**K8** 9' Ceiling to Basement  
- Risers added to stairwell

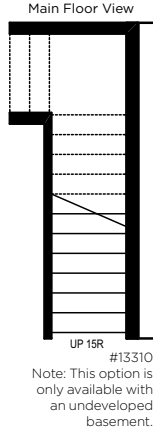

**K10** Developed Basement Stairwell

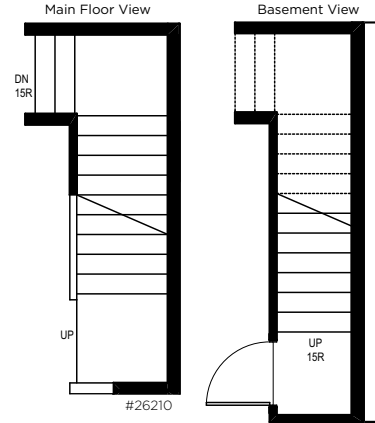

Note: This option is only available in an undeveloped basement and requires the purchase of **K8**. Door relocated to basement.

**K6** Laundry Rough-In Location to Undeveloped Basement

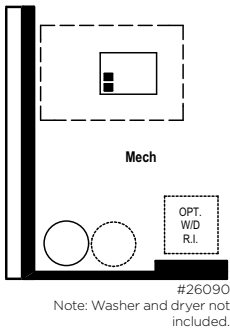

**K9** Exterior Entry to Interior Stairwell Landing  
- 6-panel entry door  
- Exterior light and switch

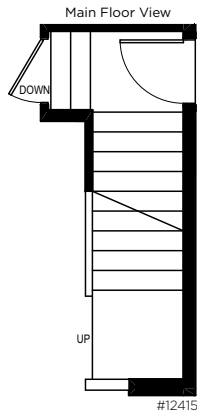

**K11** Add Door Between Main Floor and Developed Basement

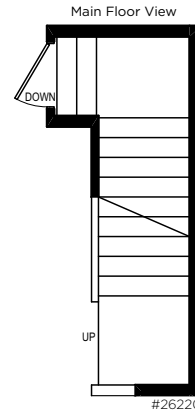

Note: This option requires the purchase of **K1** or **K10**.

**K7** Laundry Rough-In Location to Developed Basement

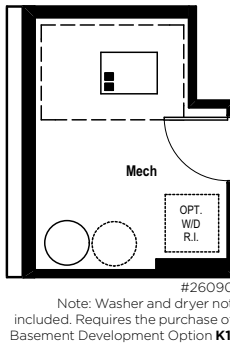

**K12** Bath Rough-In to Undeveloped Basement

